

ENGINE DRAIN LINES - MAINTENANCE PRACTICES (PT6A-140)

1. General

- A. A series of drain lines are installed to supply overboard vents for the fluids or to catch and keep it for later disposal. Drains are supplied for the following: propeller shaft, forward and aft combustion chamber, fuel manifold, fuel control, oil can assembly and drain valves.

2. Engine Drain Lines Removal/Installation

- A. Due to the simplicity of the engine drains installation, refer to Figure 201 for a guide for removal and installation.

3. Fuel Control Unit Lube Oil Drain Can Removal/Installation (For Airplanes 20800144 and On and Airplanes 208B00143 and On and Airplanes 20800001 thru 20800143 and Airplanes 208B00001 thru 208B00142 incorporating SK208-57)

- A. Remove the Fuel Control Unit Lube Oil Drain Can (Refer to Figure 201).
 - (1) Open the left upper cowling door to get access to the drain can.
 - (2) Disconnect the vent tube from the drain can.
 - (a) If necessary, loosen the bolts and washers that hold the vent tube in position.
 - (3) Loosen the clamp that attaches the Fuel Control Vent Tube to the hose.
 - (a) Disconnect the tube from the hose.
 - (4) Remove the drain valve from the drain can.
 - (5) Remove the bolts and washers that attach the drain can.
 - (6) Remove the drain can from the airplane.
- B. Install the Fuel Control Unit Lube Oil Drain Can (Refer to Figure 201).
 - (1) Put the drain can in position.
 - (2) Install the bolts and washers that attach the drain can.
NOTE: Do not tighten the bolts at this time.
 - (3) Install the drain valve in the drain can.
 - (4) Connect the vent tube to the drain can.
 - (a) Tighten the bolts and washers that hold the drain can and vent tube in position.
 - (5) Connect the hose to the Fuel Control Vent Tube.
 - (a) Tighten the clamp that attaches the Fuel Control Vent Tube to the hose.
 - (6) When the maintenance is complete, close the left upper cowling door.

4. Oil Can Assembly Removal/Installation

- A. Remove the Oil Can Assembly (Refer to Figure 201).
 - (1) Open the right upper cowling door to get access to the oil can.
 - (2) Disconnect the vent tube from the oil can.
 - (3) Disconnect the drain tube from the elbow.
 - (a) If necessary, remove the elbow from the oil can.
 - (4) Disconnect the tee from the oil can.
 - (5) Hold the oil can and loosen or remove the clamp that attaches the oil can to the bracket.
 - (6) Remove the oil can from the airplane.
- B. Install the Oil Can Assembly (Refer to Figure 201).
 - (1) Put the oil can in position in the clamp.
 - (2) Tighten the clamp that attaches the oil can to the bracket.
 - (3) Connect the tee to the oil can.
 - (4) If removed, install the elbow on the oil can.
 - (5) Connect the drain tube to the elbow.

- (6) Connect the vent tube to the oil can.
- (7) When the maintenance is complete, close the right upper cowling door.

Figure 201 : Sheet 1 : Engine Drains Installation

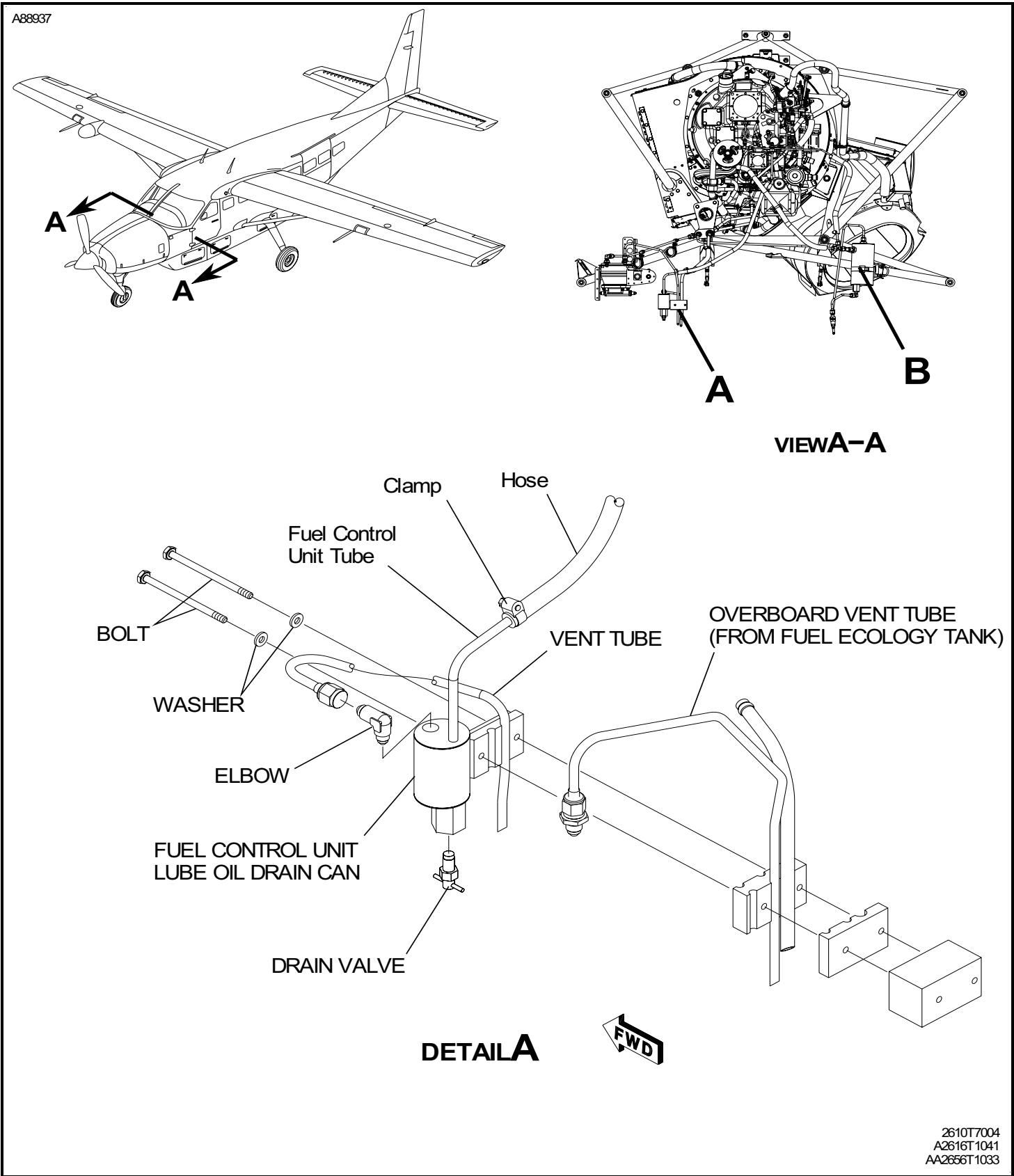
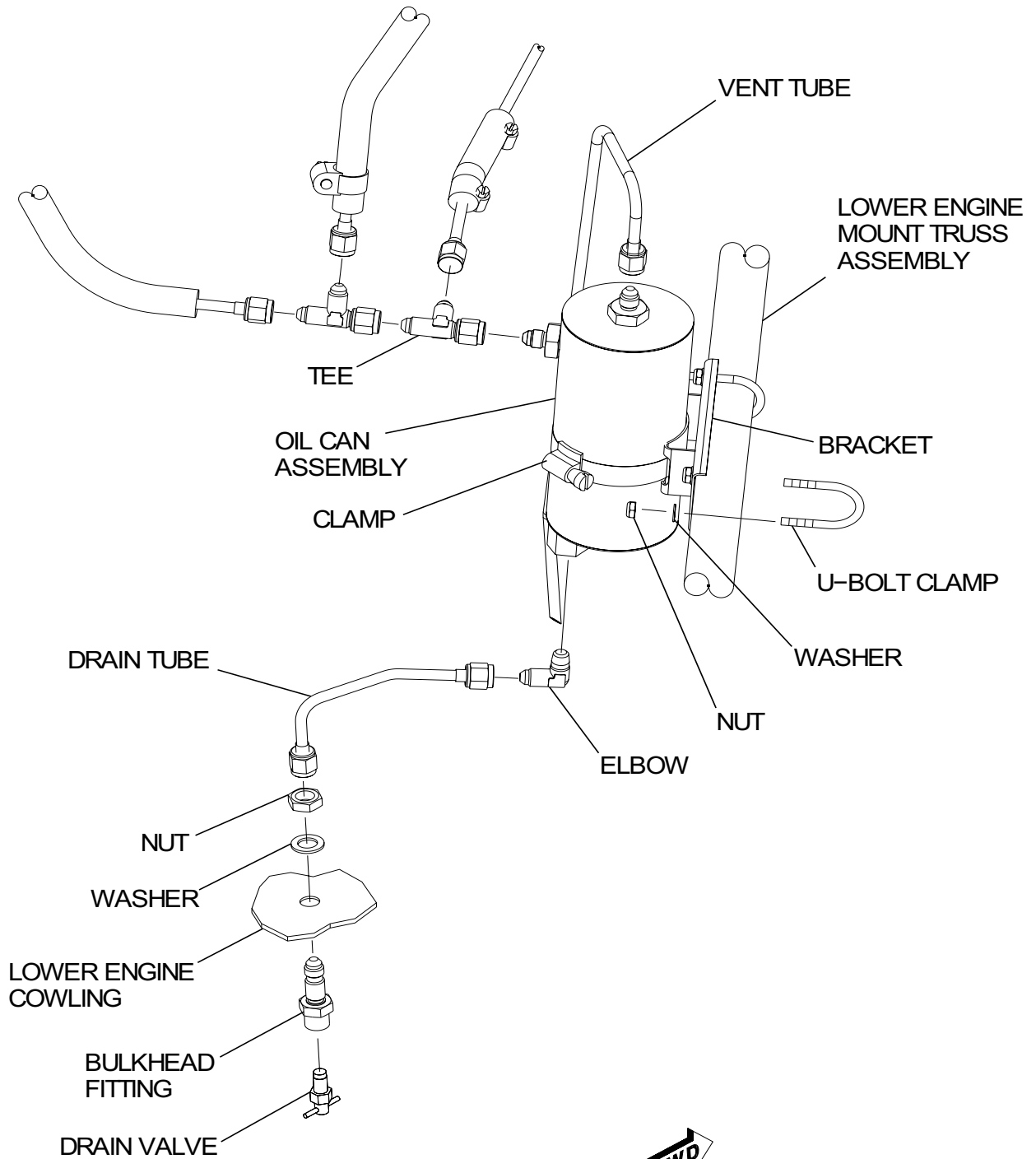

Figure 201 : Sheet 2 : Engine Drains Installation

A88938



DETAIL B



B26561035